

BASE CABINET (BC24)

CABINET PARTS LIST

A-Doors & Face Frames(2) B-End Panels(2) C-Shelf D-Bottom Panel
H-Toe Kick(2)

HARDWARE PARTS LIST

1. Shelf Clips (4) 2. Screws(Ø30*30-4) 3. Screws(Ø3*30-4)
4. Screws(Ø3*30-4) 5. Links(9)

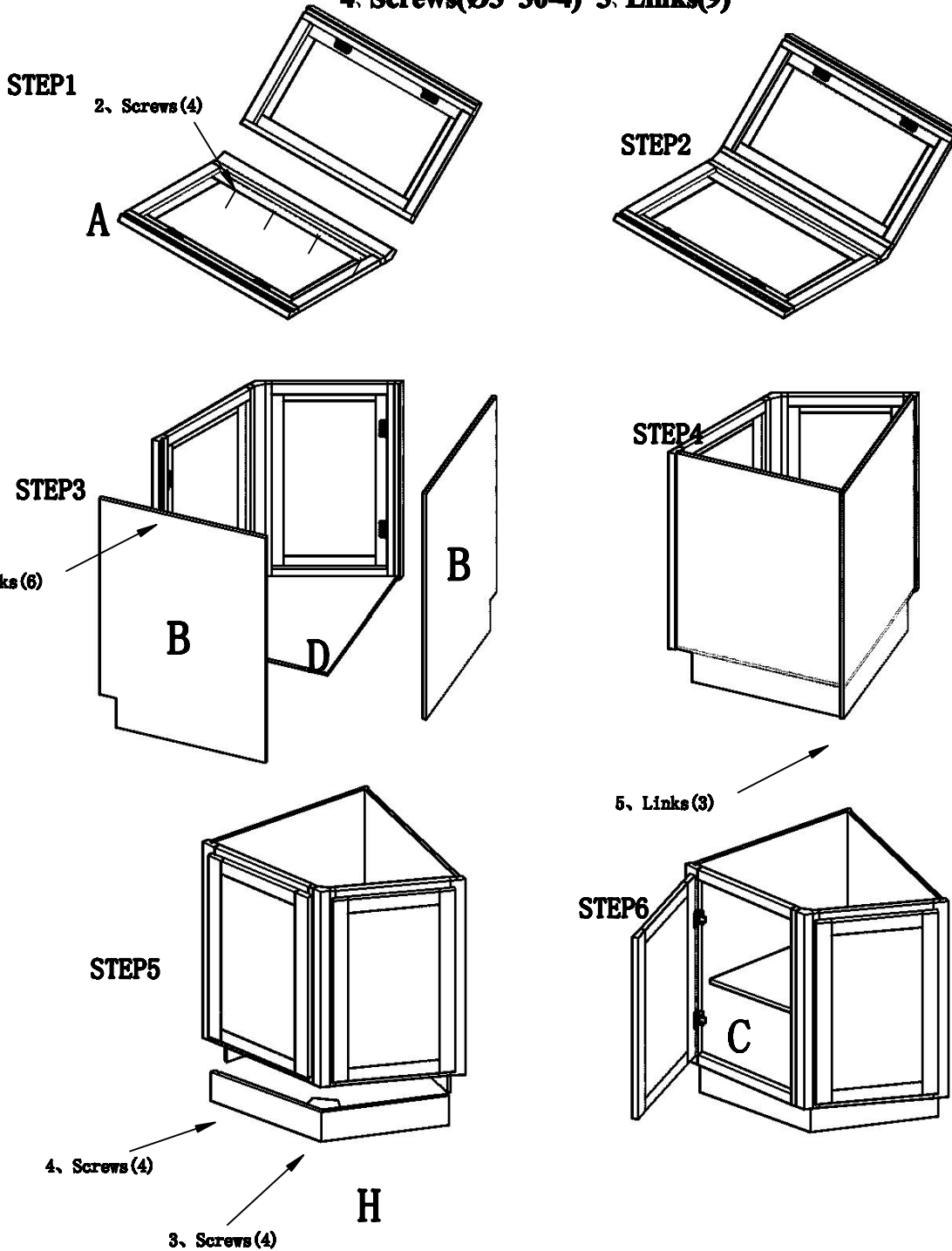

Your cabinet is complete. For installation, consult a professional contractor or building supplier for the proper installation method or materials to be used for your existing wall condition (e.g., wood, concrete, tile, etc.).