

ASSEMBLY INSTRUCTIONS

SINK BASE CABINET (SB33, SB36, SB39, SB42, SB48)

CABINET PARTS LIST

**A-Doors & Face Frame B-End Panels(2) D-Bottom Panel E-Top Back Panel
F-Bottom Back Panel H-Toe Kick J-Base Bottom Support**

HARDWARE PARTS LIST

1. Corner Braces(4) 2. Screws(Ø3.5*25-4) 3. Screws(Ø3*12-8)

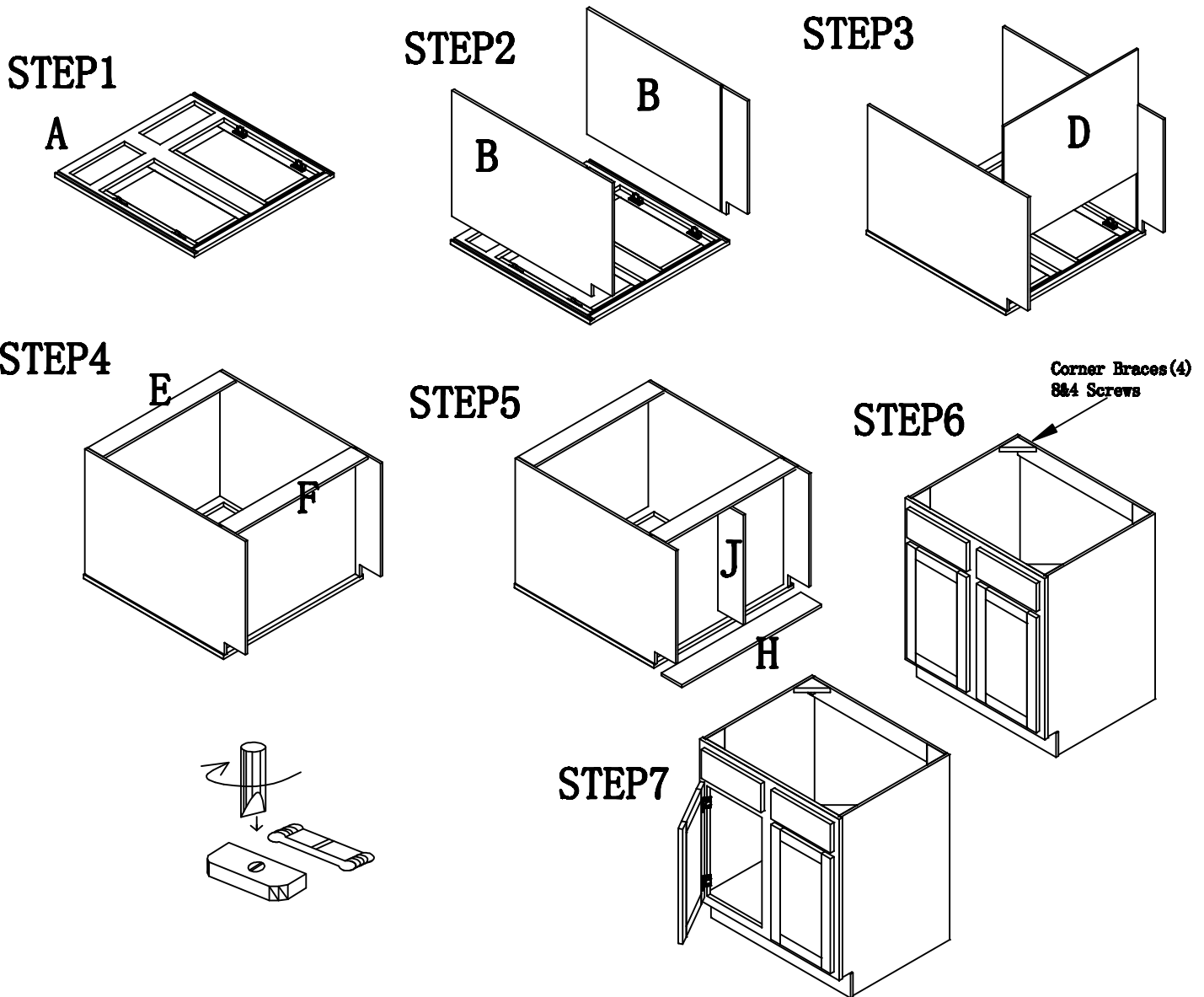

Your cabinet is complete. For installation, consult a professional contractor or building supplier for the proper installation method or materials to be used for your existing wall condition (e.g., wood, concrete, tile, etc.).