

ASSEMBLY INSTRUCTIONS

WALL CABINET (W2430, W2730, W3030, W3330)

(W3630, W3930, W4230, W4830)

(W2424, W2724, W3024, W3324, W3624)

(W2436, W2736, W3036, W3336, W3636)

(W3936, W4236, W4836, W302424, W332424, W362424)

CABINET PARTS LIST

**A-Doors & Face Frame B-End Panels(2) C-Shelves(2) D-Bottom Panel & D-Top Panel
E-Back Panel**

HARDWARE PARTS LIST

1. Shelf Clips (8) 2. Screws (Ø3.5*25) 6 OR 8

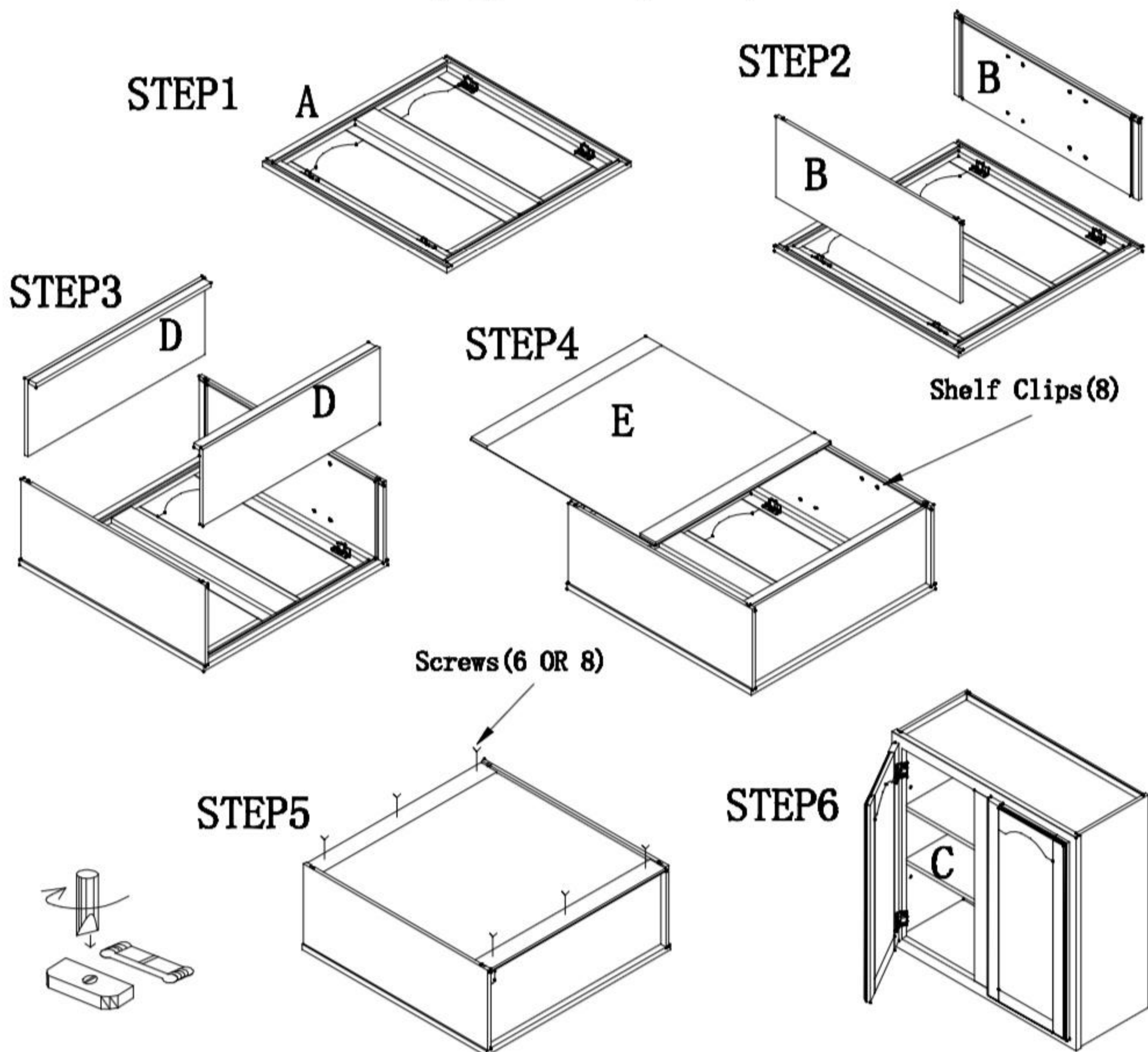

Your cabinet is complete. For installation, consult a professional contractor or building supplier for the proper installation method or materials to be used for your existing wall condition (e.g., wood, concrete, tile, etc.).